

**PROPOSED CONSOLIDATION PLAN OF:**  
**-RE-ALIGNED LOT 1, PLAN 3658,**  
**-LOT 1, PLAN VIP73194 AND**  
**-PART OF CAPITAL REGIONAL DISTRICT**  
**TITLE ES247281**

**ALL OF SECTION 23, PENDER ISLAND,**  
**COWICHAN DISTRICT**

**NOTE:**  
 LOT 1, PLAN 3658 IS SUBJECT TO  
 THE FOLLOWING EASEMENT CHARGES:  
 -EG37971 (LOCATION NOT IDENTIFIED)  
 -EL18235

**LEGEND:**

SCALE 1:250 

ALL DIMENSIONS ARE EXPRESSED AS  
 METERS AND DECIMALS THEREOF.

- INDICATES IRON PIN
- INDICATES SEWER TREATMENT TANK VENT
- OF INDICATES DOUGLAS FIR

**AREAS CLOSED:**

PART CRD: +/- 3.88 SQ. M.  
 ROAD: +/- 31.31 SQ. M.  
 WELL SITE: +/- 32.87 SQ. M.  
 TOTAL: +/- 68.06 SQ. M.

**AREAS DEDICATED ROAD:**

ROAD AREA: +/- 11.08 SQ. M.  
 GRAVEL PARKING: +/- 56.98 SQ. M.  
 TOTAL: +/- 68.06 SQ. M.

**FOR DISCUSSION  
 PURPOSES ONLY**

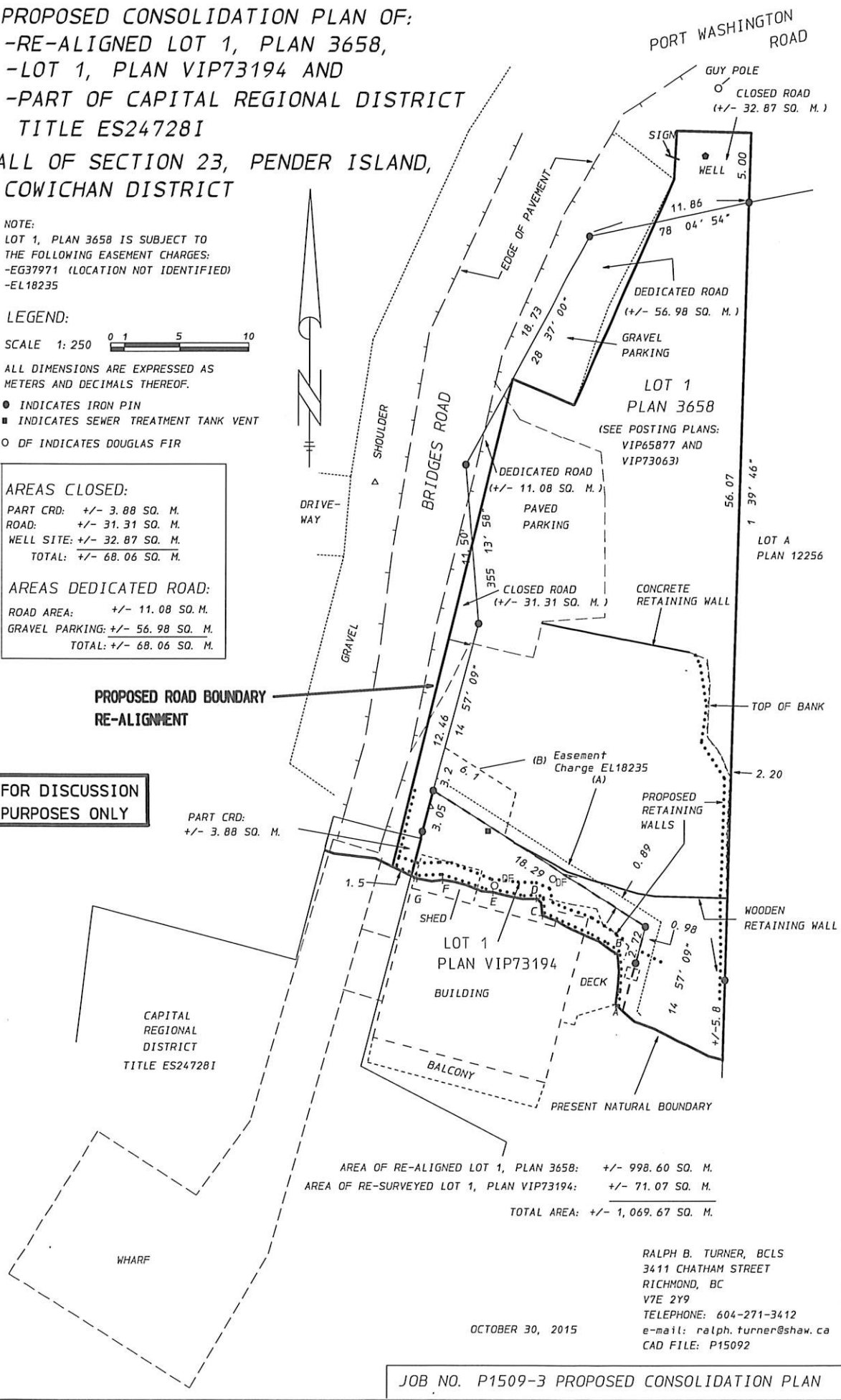

AREA OF RE-ALIGNED LOT 1, PLAN 3658: +/- 998.60 SQ. M.  
 AREA OF RE-SURVEYED LOT 1, PLAN VIP73194: +/- 71.07 SQ. M.  
**TOTAL AREA: +/- 1,069.67 SQ. M.**

RALPH B. TURNER, BCLS  
 3411 CHATHAM STREET  
 RICHMOND, BC  
 V7E 2Y9  
 TELEPHONE: 604-271-3412  
 e-mail: ralph.turner@shaw.ca  
 CAD FILE: P15092

OCTOBER 30, 2015